

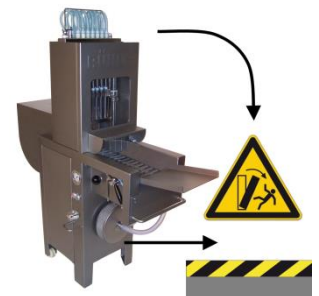

Quick installation guide

I • Installing the machine

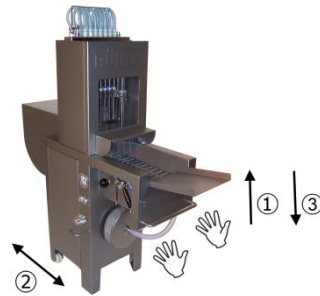
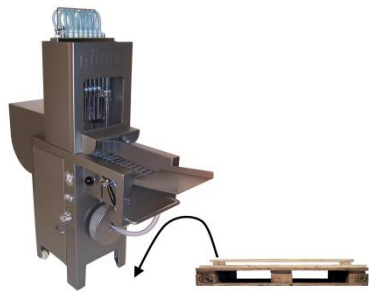

II • Operation

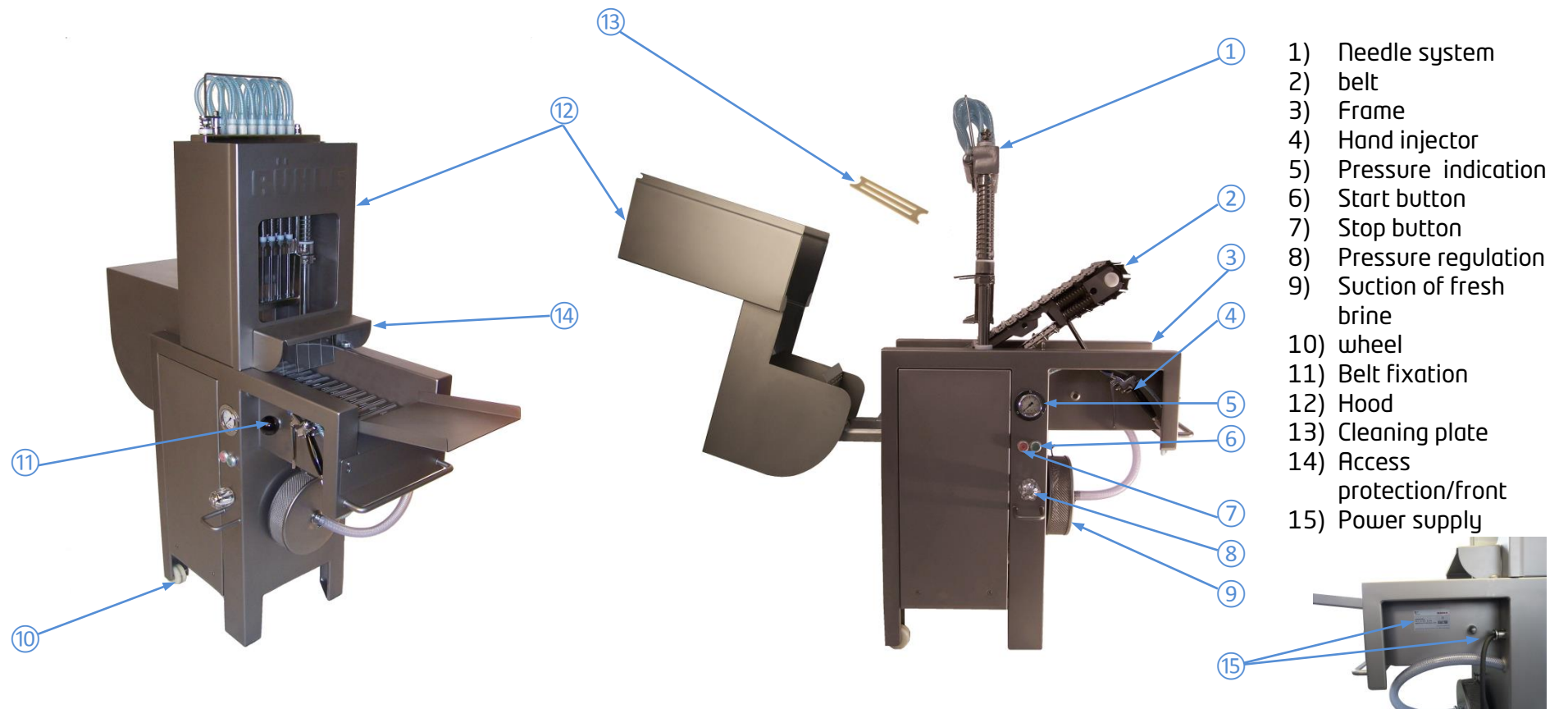

15 • Power supply

14 • Access protectin

12 • Hood

14 • Unlocking the front

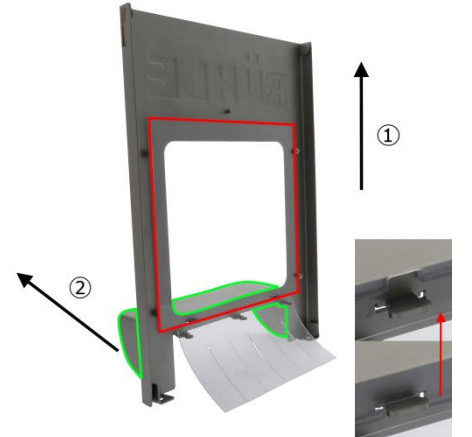
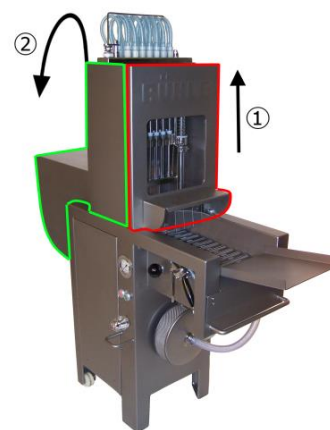

III • Initial operation

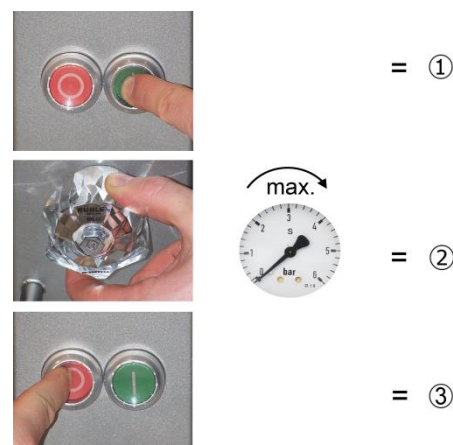
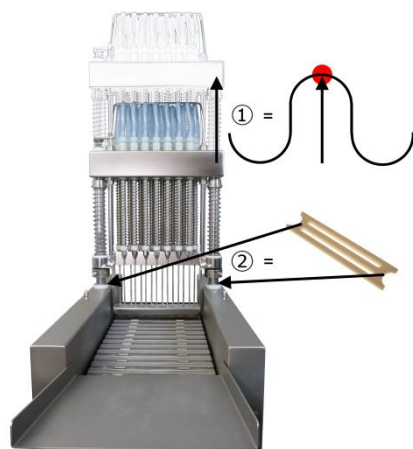

Running time = approx. 3 min.

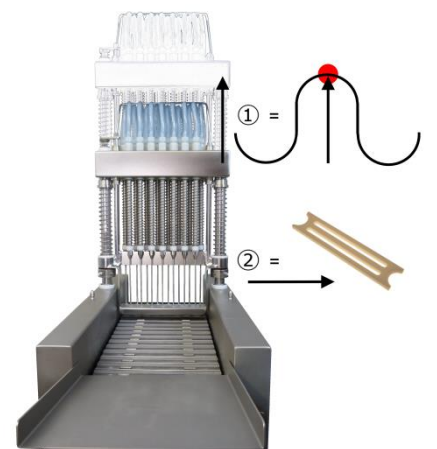

IV • Unlocking the belt

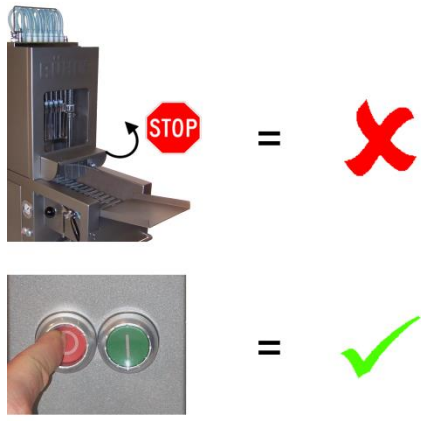

11 • Belt fixation



2 • Belt



V • Cleaning (hose system)

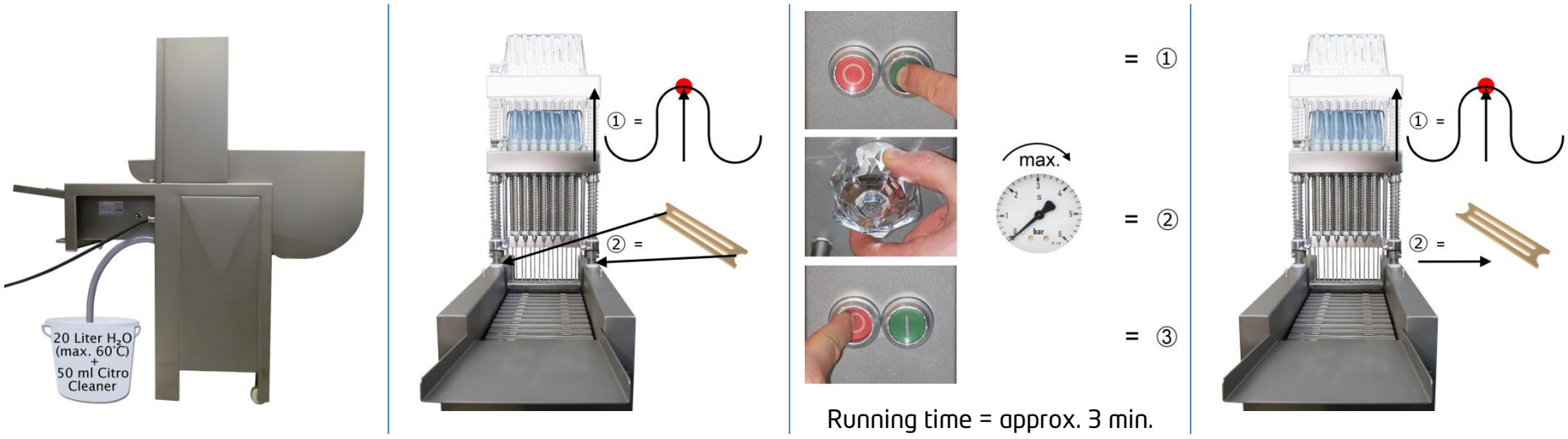

VI • Cleaning (operation area)

