

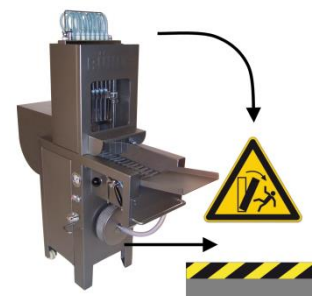

I • Maschine aufstellen

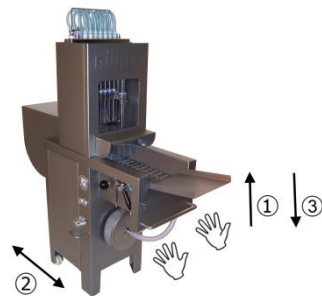

II • Bedienung

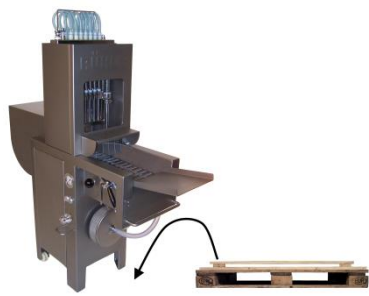
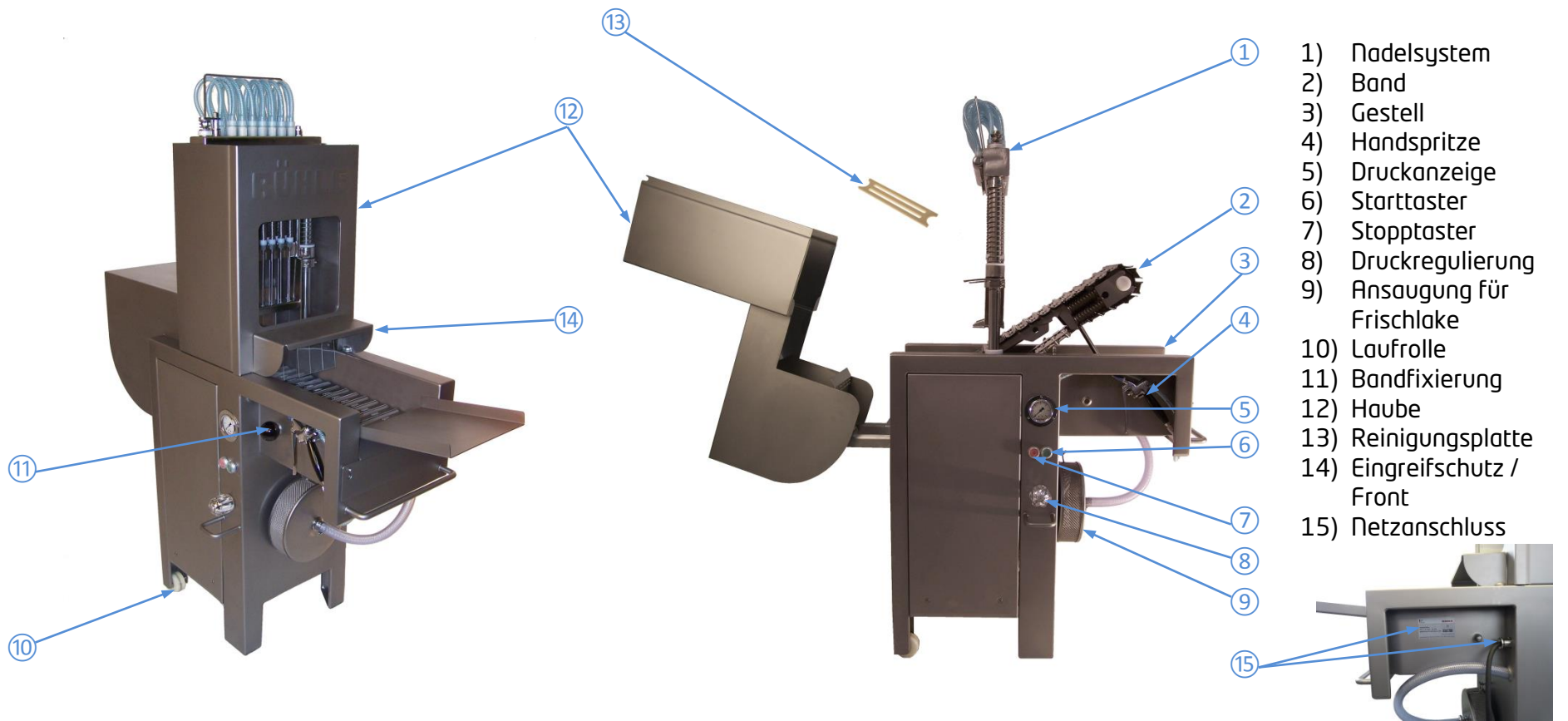

15 • Netzanschluss



14 • Eingreifschutz



12 • Haube

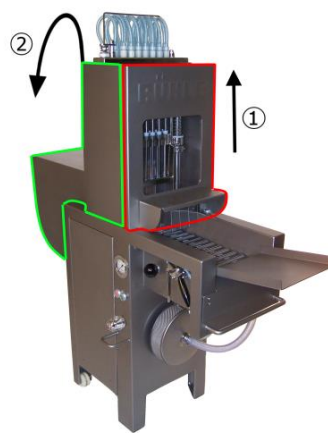

14 • Front entriegeln

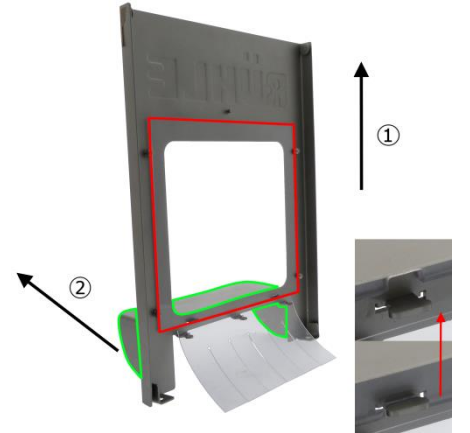

III • Erstinbetriebnahme

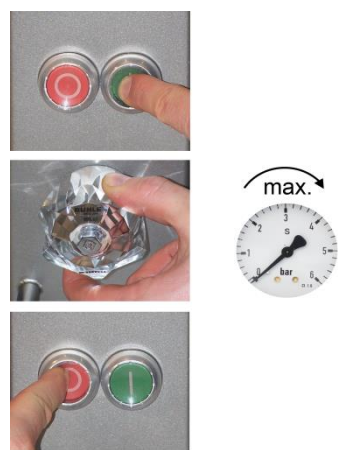
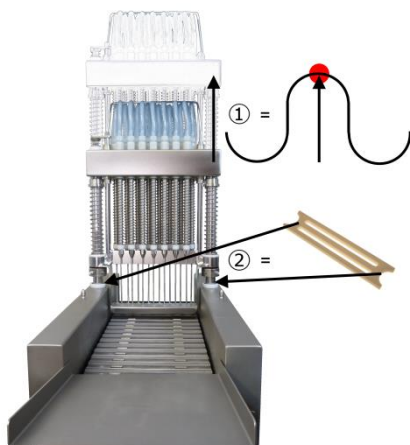

Laufzeit = ca. 3 min.

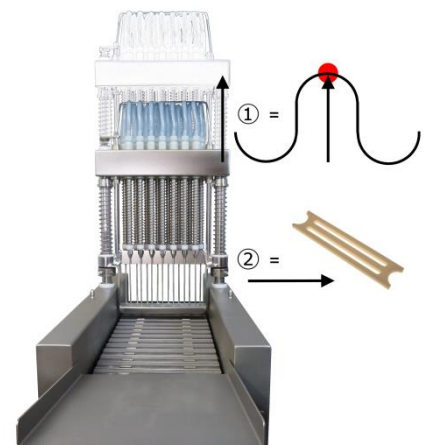

IV • Band entriegeln

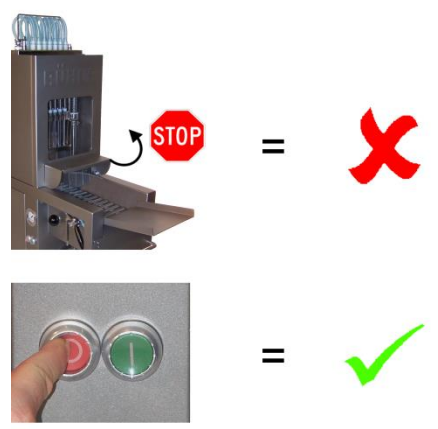

11 • Bandfixierung



2 • Band



V • Reinigung (Schlauchsystem)

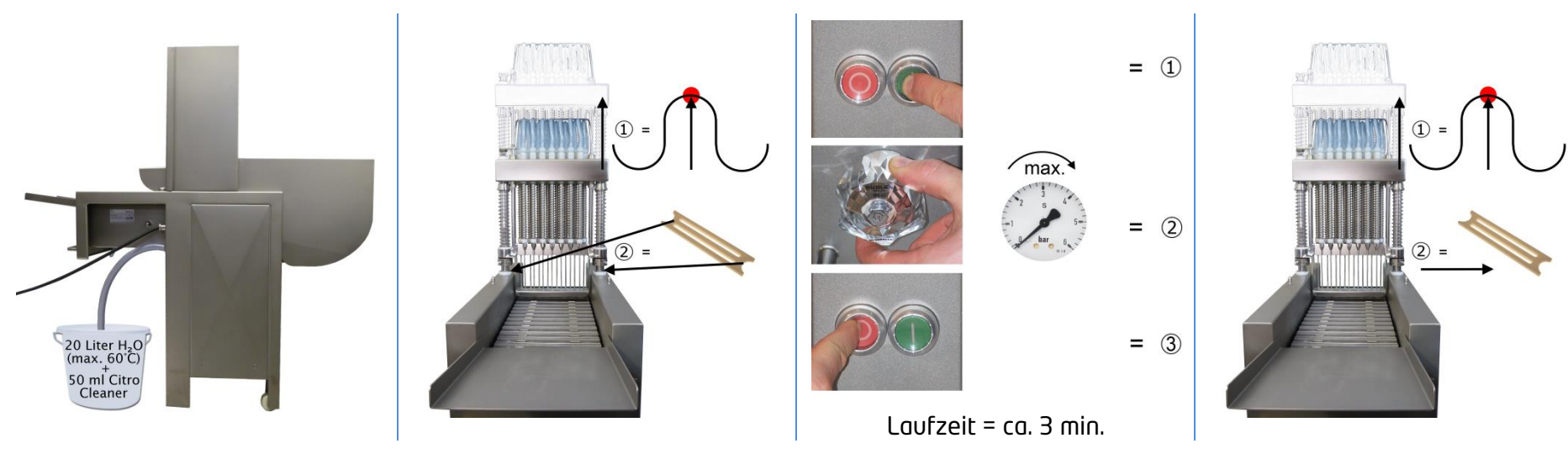

VI • Reinigung (Arbeitsbereich)

